

NOTES

- (102) APPLICABLE STANDARDS AND SPECIFICATIONS:
ASME Y14.5-1994, DIMENSIONING AND TOLERANCING
ASME Y1.1, ABBREVIATIONS
ASME Y14.36, SURFACE TEXTURE SYMBOLS
- (507) BAG OR TAG WITH LABEL USING .125 IN. [3mm] HIGH CHARACTERS IN ACCORDANCE WITH MIL-STD-130. USING FORMAT:
(511) LINE 1: M4200301-MDE-2000-0352 REV: 001
- (701) THE SELLER SHALL PACKAGE THE PART TO MAINTAIN CLEANLINESS AND TO PREVENT DAMAGE DURING HANDLING AND SHIPMENT TO THE SITE SPECIFIED ON THE PURCHASE ORDER.
- (702) SHIPPING CONTAINERS SHALL BE MARKED TO INDICATE THE FOLLOWING:
 - FRIB PURCHASE ORDER NUMBER
 - SHIPPING ADDRESS AS SPECIFIED ON THE PURCHASE ORDER, INCLUDING THE BUILDING NUMBER
 - "FRIB CONTACT" AS SPECIFIED ON THE PURCHASE ORDER
 - CONTENTS CONTAINED IN THE PACKAGE(S)
 - SELLER'S NAME
 - "TOP SIDE UP," IF REQUIRED
 - "FRAGILE," IF REQUIRED
 - "DO NOT OPEN" LABEL. MINIMUM OF ONE LABEL PER SIDE PER SHIPPING CONTAINER.

| REVISIONS | | | | |
|-----------|------|-------------|------------|-----------|
| ZONE | REV. | DESCRIPTION | DATE | APPROVED |
| | 1 | RELEASED | 2021-11-16 | N.BULTMAN |

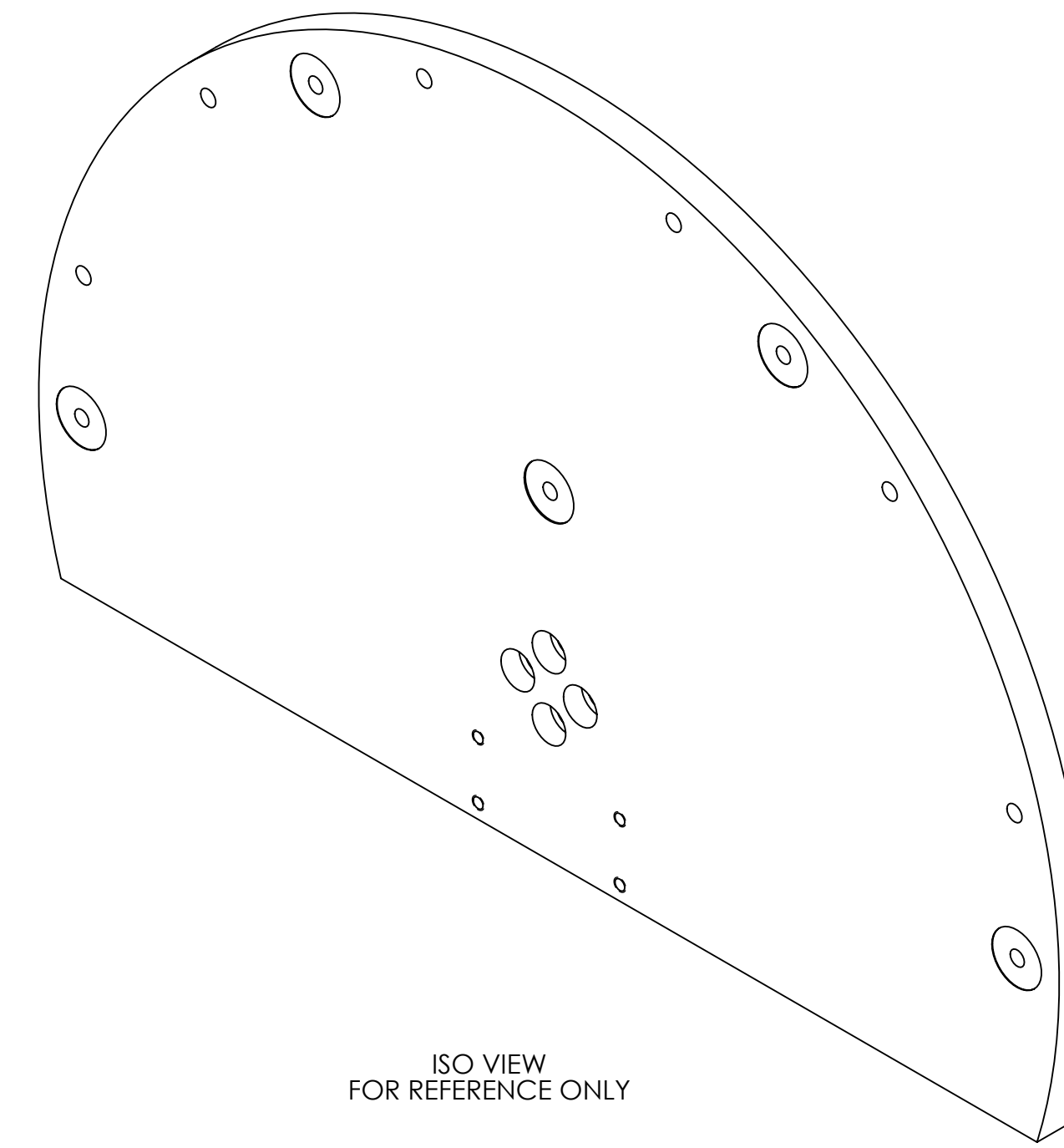

ISO VIEW FOR REFERENCE ONLY

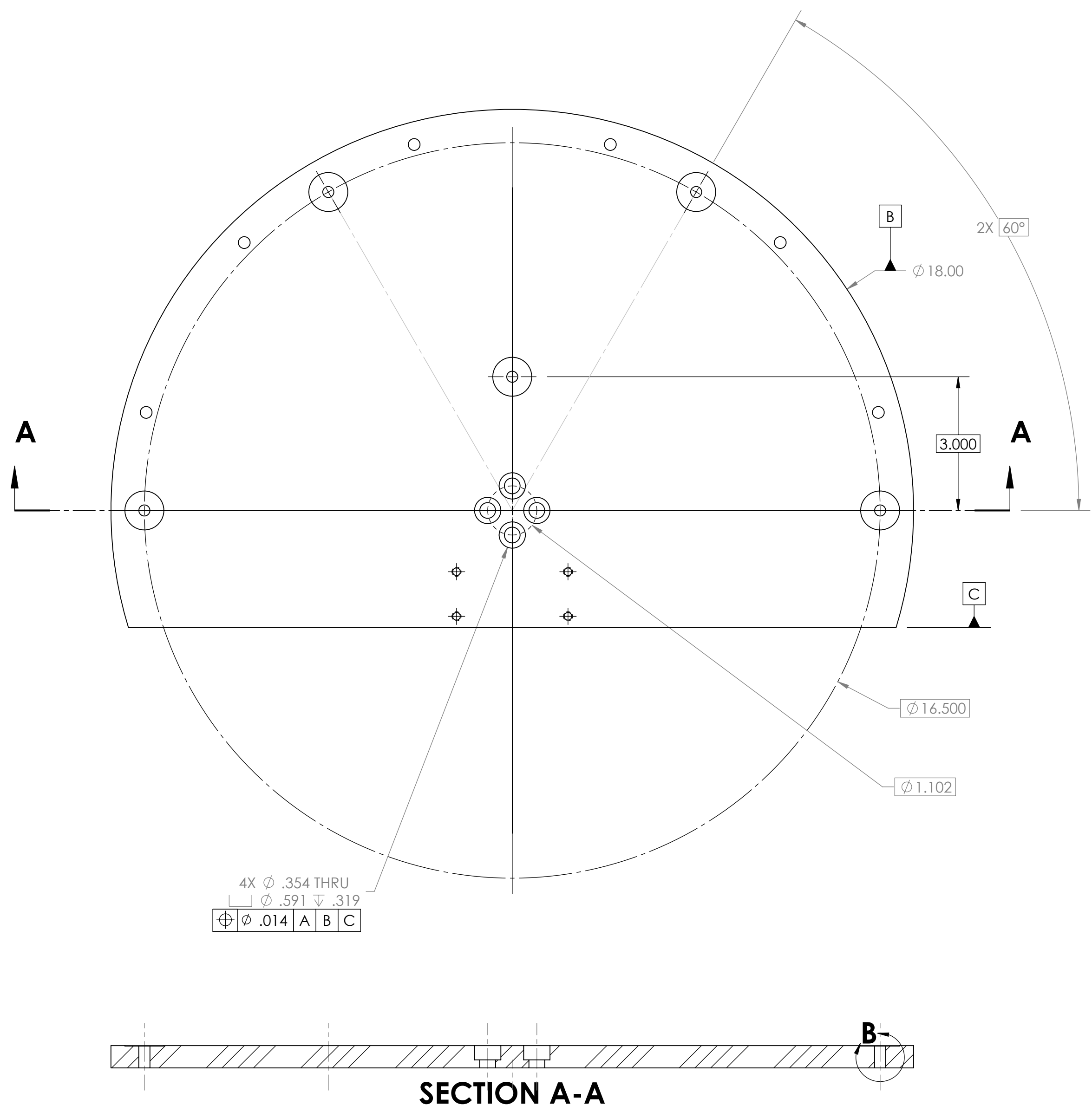

SECTION A-A

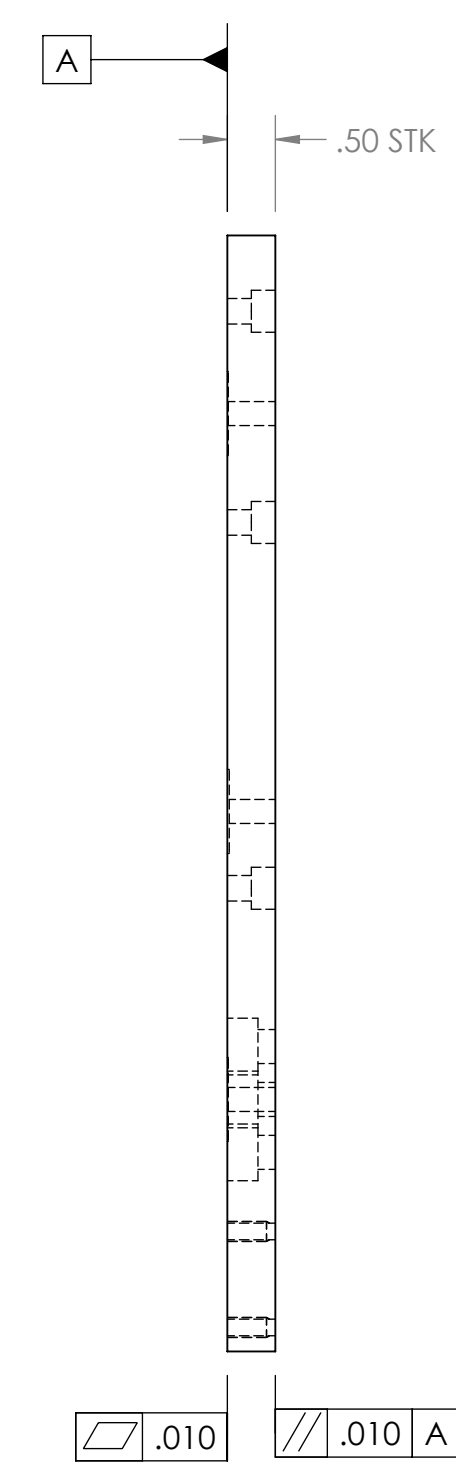

DETAIL B
5X TYP.
SCALE 2 : 1

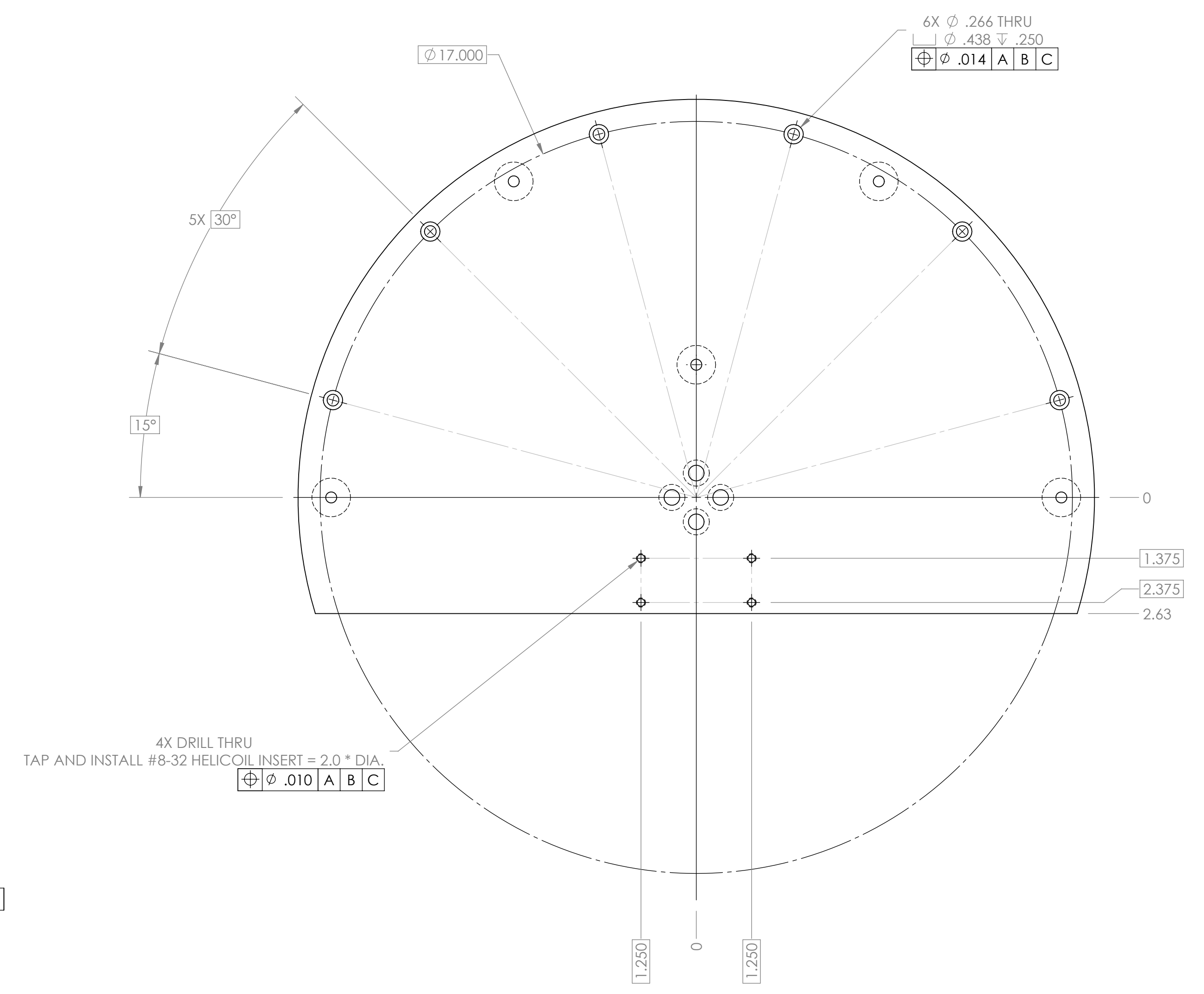

| UNLESS OTHERWISE SPECIFIED: | | | | APPROVAL | NAME | DATE |
|---|--|--|--|---------------------|-------------|------------|
| DIMENSIONS ARE IN INCHES | | | | DRAWN | N.BULTMAN | 2021-11-15 |
| TOLERANCES: | | | | | | |
| FRACTIONAL: 1/16" | | | | CHECKED | N.BULTMAN | 2021-11-15 |
| ANGULAR: MAXIMUM .1° BOND .11" | | | | | | |
| ONE PLACE DECIMAL: ± .01 | | | | ENGINEER | S.BROOKHUIS | 2021-11-15 |
| THREE PLACE DECIMAL: ± .005 | | | | | | |
| BREAK ALL SHARP EDGES .02" | | | | MFG LEADER | N.BULTMAN | 2021-11-15 |
| DIMENSIONING AND TOLERANCING IN ACCORDANCE WITH ASME Y14.5-1994 | | | | | | |
| MATERIAL: ALGAS TOOLING PLATE | | | | MATERIAL CERT REQS: | MFG | MFG |
| FINISH: DO NOT SCALE DRAWING | | | | | | |

DRAWINGS WITHOUT DCC WATERMARK ARE FOR REFERENCE ONLY